

GLAST Large Area Telescope

WBS 4.1.B

**Instrument Science Operations Center
Monthly Status Review
30 Sept 2004**

**Rob Cameron
rac@slac.stanford.edu
650-926-2989**

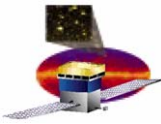

September Accomplishments (1)

- ❑ **Continued responses to CDR and GSDR RFAs**
 - Responses provided for 6 of the 8 CDR RFAs.
 - Still in work: RFA#6 “Launch Critical Support Plan”. Working with GOWG to identify Launch Critical and Mission Critical products. Information on LAT support requirements at MOC provided to John Nagy. Approx. 12 LAT computers will be present at the MOC during L&EO, not on the secure IONET. During L&EO, data will be flowed to the LAT computers at the MOC (through a gateway computer) and to the ISOC. Details and other support requirements (voice loops, MOC console monitors, etc) are still being worked.
 - Still in work: RFA#7 “Red/Yellow Limit Philosophy”. Waiting for definitions from Spectrum Astro. ISOC policy is to adhere to project definitions.

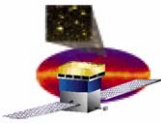

CDR RFA Status

Section	RFA Title	Requestor	Actionee	ECD/Comments	Sent to Originator for Review	Submitted to Chairpersons	Closed
1	ISOC Documentation Tree	E. Andrews	L. Bator	Response submitted	8/12/04		
2	Requirements Traceability Tool	E. Andrews	B. Craig J. Martin	Response submitted	8/27/04	9/07/04	
3.1	Add ISOC Architecture Diagram	E. Andrews	B. Craig	Response submitted	8/16/04		
3.4	ISOC Requirements & Testing (Overall)	E. Andrews	J. Martin	Response submitted	9/14/04		
4.2	SAA Handling Approach	N. Johnson	L. Bator	Response submitted	8/30/04		
4.2	Launch Critical Support Plan	M. Rackley J. Leibee	S. Culp	9/30/04 Awaiting GSFC inputs			
4.2	Red/Yellow Limit Philosophy	J. Leibee	L. Bator	9/30/04 Awaiting SAI definitions			
8	SAS Verification Approach	M. Rackley	J. Martin	Response submitted	9/14/04		

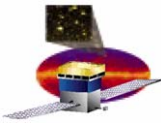

September Accomplishments (2)

□ Management

- **Key ISOC issues being addressed: ISOC coordination with other project elements; staffing requirements; facility requirements**
- **FSW: Worked with Jeff Fisher to draft FSW support requirements in the ISOC after FSW QT for 2 periods: FQT-launch, post-launch**
- **FSW: Following FSW Peer Review, defined elements of FSW ICD for ISOC, to be refined through FSW/ISOC TIMs**
- **I&T: Working with I&T to define transition plan for SVAC to PVO, and pre-launch roles and responsibilities**
- **SAS: Working with Science Analysis team to identify software and processing responsibilities**
- **Working with LAT PI, NRL and GSFC on external ISOC support functions**
- **Review of draft MOA on IFC OCF for ISOC support**



September Accomplishments (3)

- ❑ **LAT Operations Planning and Development**
 - **Completed ISOC GSRD-L2-L3 requirements tracing.**
 - **Resolving TBXs in ISOC requirements.**
 - **Database development: construction of LAT and S/C HK telemetry trending database in mySQL and Oracle in conjunction with FSW. Construction of prototype query tool in conjunction with I&T.**
 - **Documentation: Preparation of Instrument Data Analysis Handbook (LAT-PS-04631) for I&T, for LAT Collaboration meeting. Initial outline of ISOC Software Architecture document. Continued work on ISOC Operations Plan (LAT-SS-01378).**

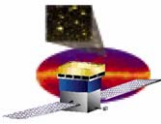

ISOC Staffing

- ❑ **CHS**
 - Interviewing for CHS Software Developer: good candidate identified
 - Test Engineer: resumes being obtained
- ❑ **FSW**
 - Coordinated on hire of FSW Test Engineer/Physicist
- ❑ **SAS**
 - Agreed to support SAS software infrastructure person
- ❑ **Other**
 - Support for GLAST JAS3/Java developer position in SCS, for SAS and possible CHS use of JAS3

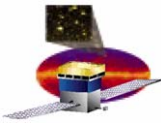

ISOC Operations Facility

- ❑ Working with SLAC management and SLAC Facilities to define and satisfy near-term ISOC facility requirements
- ❑ Coordinating ISOC requirements with LAT project management
- ❑ Two near-term options being considered, to be located opposite Building 028:
 - 60'x24' building. 7 desks + Operations Center. Probably 12 week timescale.
 - 60'x36' building. 10-12desks + Operations Center. Probably 16 week timescale.
- ❑ Long-term ISOC facility: initial discussions with SLAC and KIPAC management on possible ISOC presence in new Kavli building at SLAC. Some ISOC presence (TBD) on Stanford campus.

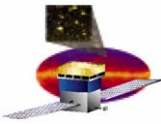

Proposed ISOC Layout for 60'x36' Trailer

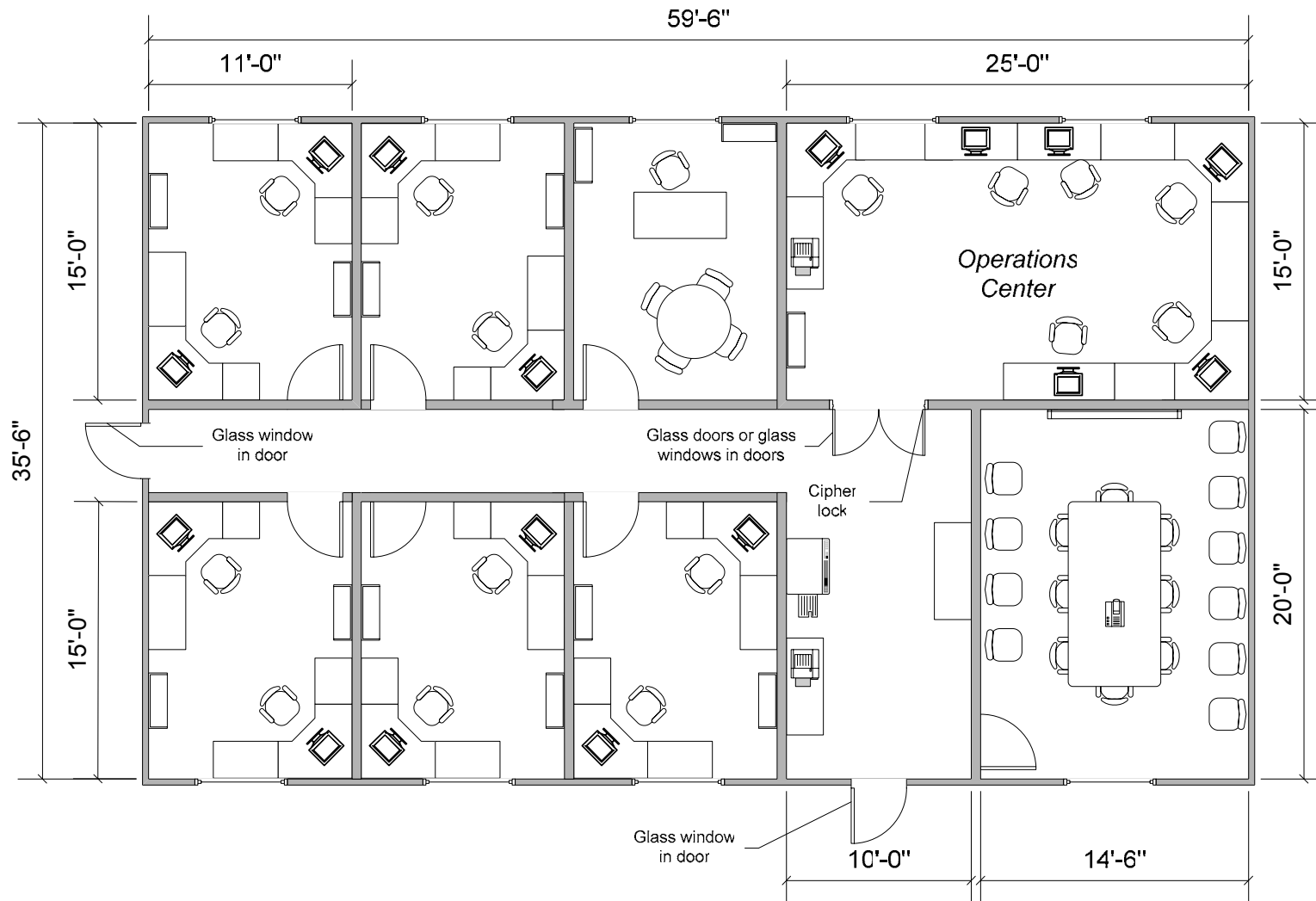



Proposed ISOC Layout for 60'x24' Trailer

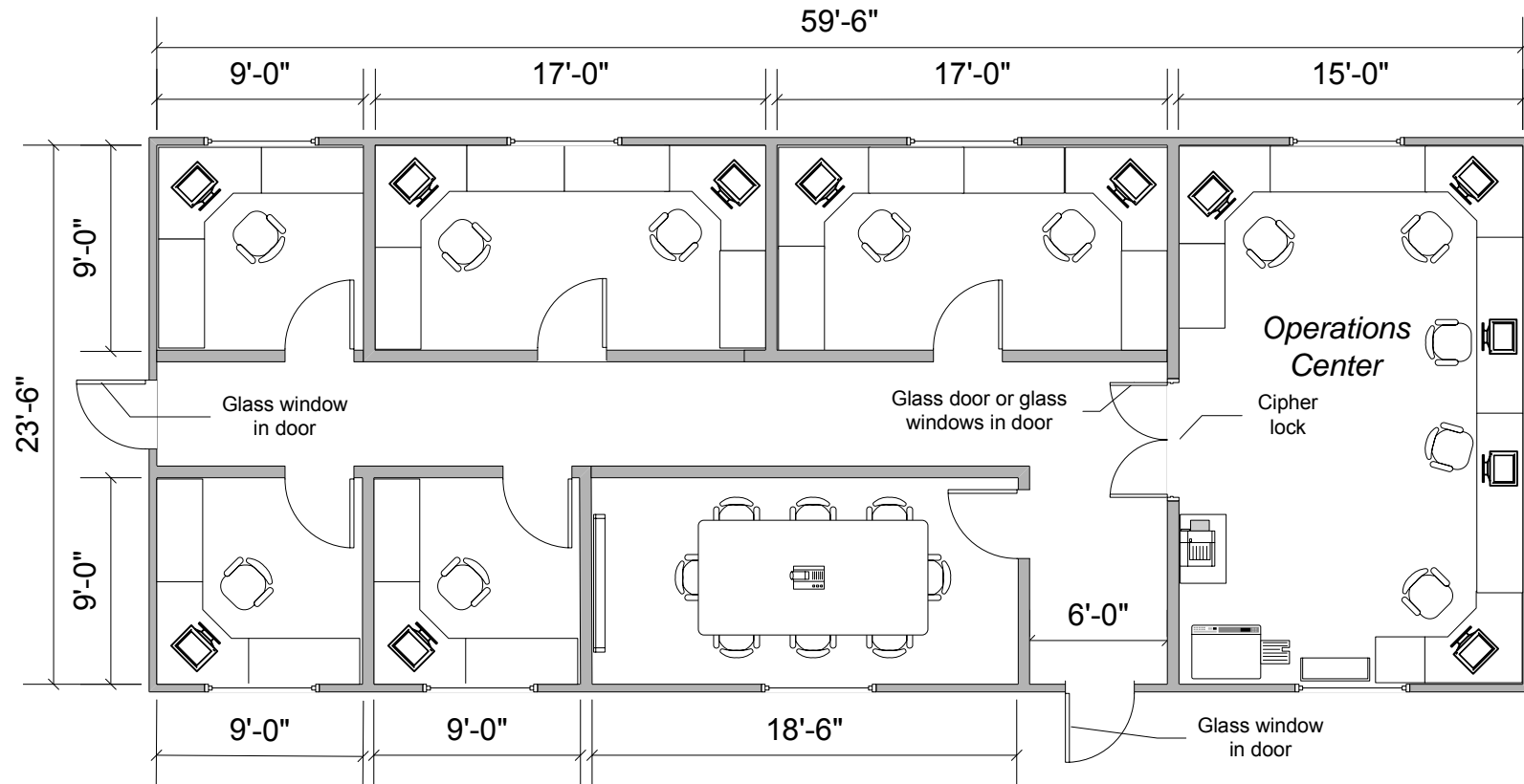

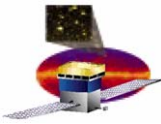

Plans for October

- ❑ **Review/revise ISOC budget for SLAC RD for FY2005 and beyond**
- ❑ **Initiate purchase of temporary ISOC building**
- ❑ **Hire CHS software developer**
- ❑ **Conduct search, interviews for CHS Test Engineer**
- ❑ **Refine schedule details for CHS software development plan**
- ❑ **Initial demonstration of ISOC telemetry trending database and GUI query engine**
- ❑ **Continue coordination between ISOC and other LAT elements**